

**NYLON ANCHORS WITH MOUNTED NAIL
 ROUND HEAD**

PART NUMBER	SIZE	HEAD TYPE	DRILL SIZE	BOX QTY.	PRICE / C
809NAOR61	3/16" X 1"	ROUND	3/16"	100	\$6.29
809NAOR81	1/4" X 1"	ROUND	1/4"	100	\$6.41
809NAOR85	1/4" X 1-1/2"	ROUND	1/4"	50	\$9.77
809NAOR82	1/4" X 2"	ROUND	1/4"	50	\$15.05

Meets or exceeds GSA Specification FF-S-325, Group V, Type 2, Class 4.

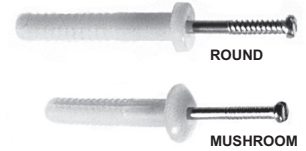

- Nylon.
- Clear Color.
- Mounted Nail.
- Screw Type Nail.

Installation for both NYLON & ZINC Anchors:

**NYLON ANCHORS WITH MOUNTED NAIL
 MUSHROOM HEAD**

PART NUMBER	SIZE	HEAD TYPE	DRILL SIZE	BOX QTY.	PRICE / C
809NAOM61	3/16" X 1"	MUSHROOM	3/16"	100	\$6.29
809NAOM65	3/16" X 1-1/2"	MUSHROOM	3/16"	100	\$9.77
809NAOM80	1/4" X 3/4"	MUSHROOM	1/4"	100	\$6.29
809NAOM81	1/4" X 1"	MUSHROOM	1/4"	100	\$6.41
809NAOM85	1/4" X 1-1/2"	MUSHROOM	1/4"	100	\$9.77
809NAOM82	1/4" X 2"	MUSHROOM	1/4"	50	\$15.05
809NAOM83	1/4" X 3"	MUSHROOM	1/4"	50	\$17.76
809NAOM84	1/4" X 4"	MUSHROOM	1/4"	50	\$22.03

Meets or exceeds GSA Specification FF-S-325, Group V, Type 2, Class 4.

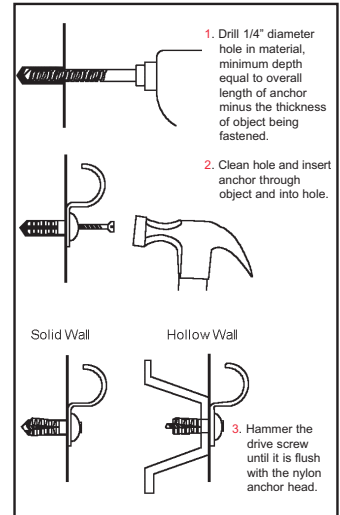

These versatile anchors can be used in hollow and solid masonry, plaster, brick, stone, as well as in sheet metal.

**ZINC HAMMER DRIVE ANCHORS
 MUSHROOM HEAD**

PART NUMBER	SIZE	HEAD TYPE	DRILL SIZE	BOX QTY.	PRICE / C
810HD14340	1/4" X 3/4"	MUSHROOM	1/4"	100	\$16.73
810HD14010	1/4" X 1"	MUSHROOM	1/4"	100	\$17.05
810HD14114	1/4" X 1-1/4"	MUSHROOM	1/4"	100	\$18.51
810HD14112	1/4" X 1-1/2"	MUSHROOM	1/4"	100	\$21.35
810HD14200	1/4" X 2"	MUSHROOM	1/4"	100	\$28.31

Meets or exceeds GSA Specification FF-S-325, Group V, Type 2, Class 3.



NOTE: All anchor prices subject to change.